

April

Hydrant Schedule

2023

Sunday	Monday	Tuesday	Wednesday	Thursday	Friday	Saturday
						1
2	3 Zone 1,4,7,10	4 Zone 2,5,8,11	5 Zone 3,6,9,12	6 Zone 1,4,7,10	7 Zone 2,5,8,11	8
9	10 Zone 2,5,8,11	11 Zone 3,6,9,12	12 Zone 1,4,7,10	13 Zone 2,5,8,11	14 Zone 3,6,9,12	15
16	17 Zone 3,6,9,12	18 Zone 1,4,7,10	19 Zone 2,5,8,11	20 Zone 3,6,9,12	21 Zone 1,4,7,10	22
23	24 Zone 1,4,7,10	25 Zone 2,5,8,11	26 Zone 3,6,9,12	27 Zone 1,4,7,10	28 Zone 2,5,8,11	29
30						

Hydrant Testing

April 3, 6, 12, 18, 21, 24, and 27, 2023

Enlarged maps are available at www.ashlandky.gov

Zone 1

From Martin Luther King to Hooks Creek Pike, from River to Montgomery Avenue. This area will include Providence Hill Drive, River Hill Drive, and Ashland Towne Center Mall.

Zone 4

17th Street to 29th Street from the River to Hilton Avenue. This zone will also cover 29th Street to 31st Street, between the River and Montgomery Avenue.

Zone 7

From Hilton Avenue at Prospect Avenue to the 29th Street/Belmont Split. From Belmont Street at 29th Street including all neighborhoods on the west side of Belmont Street; from Moore Street at Lydia Street to 29th Street, following 29th Street to the intersection with Blackburn Avenue. From Blackburn Avenue and 29th Street intersection to Oakview Road, including everything east of Oakview Road to 13th Street.

Zone 10

29th Street from Moore Street to Poage School. Out Robin Lynn Drive extending in a straight line through Terrace Blvd to Valleyview Drive from Valleyview Drive at South Belmont to Blackburn Avenue to Belmont Street. Down Belmont Street to 39th Street.

CONSUMERS ARE ADVISED TO CHECK WATER CONDITIONS PRIOR TO DRAWING WATER FOR CONSUMPTION, COOKING, AND FOR USE IN WASHERS AND DISHWASHERS. There may be a slight drop in pressure or a presence of discoloration from the minerals and sediments being flushed out of the system. If discoloration is found, run water until water clears.

OHIO

MILE 323 X

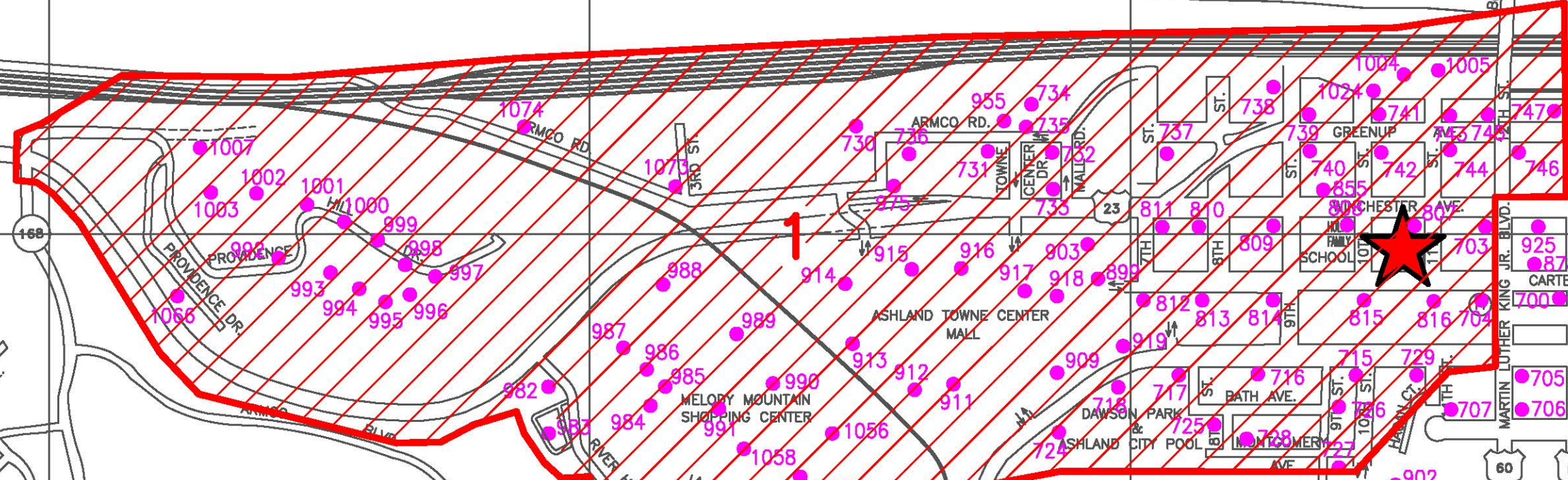

RD.

168

BLVD.
AVE.
VERNA AVE.
FRENCH BROAD ST.
JOHNSON ST.
HEATLEY ST.
FE ST.

ELLINGTON HIGH ST.

AVE.

STEVENS AVE.

AVE.

WEST CENTRAL AVE.

ELIZABETH RD.

SON RD.
BALDRIDGE CT.
H ST.

CLEMENTS DR.

FLORIDA ST.

MCKINLEY ST.

HILTON ST.

PROVIDENCE DR.
PROVIDENCE

ARMCO BLVD.

ARMCO RD.

RIVER HILL DR.

ASHLAND TOWNE CENTER MALL

MELORY MOUNTAIN SHOPPING CENTER

ASHLAND TOWNE CENTER MALL

DAWSON PARK

ASHLAND CITY POOL

BATH AVE.

MONTGOMERY AVE.

HANCOCK ST.

10TH ST.

9TH ST.

8TH ST.

7TH ST.

6TH ST.

5TH ST.

4TH ST.

3RD ST.

2ND ST.

1ST ST.

0TH ST.

-1ST ST.

-2ND ST.

-3RD ST.

-4TH ST.

-5TH ST.

-6TH ST.

-7TH ST.

-8TH ST.

-9TH ST.

-10TH ST.

-11TH ST.

-12TH ST.

-13TH ST.

-14TH ST.

-15TH ST.

-16TH ST.

-17TH ST.

-18TH ST.

-19TH ST.

-20TH ST.

-21ST ST.

-22ND ST.

-23RD ST.

-24TH ST.

-25TH ST.

-26TH ST.

-27TH ST.

-28TH ST.

-29TH ST.

-30TH ST.

-31ST ST.

-32ND ST.

-33RD ST.

-34TH ST.

-35TH ST.

-36TH ST.

-37TH ST.

-38TH ST.

-39TH ST.

-40TH ST.

-41ST ST.

-42ND ST.

-43RD ST.

-44TH ST.

-45TH ST.

-46TH ST.

-47TH ST.

-48TH ST.

-49TH ST.

-50TH ST.

-51ST ST.

-52ND ST.

-53RD ST.

-54TH ST.

-55TH ST.

-56TH ST.

-57TH ST.

-58TH ST.

-59TH ST.

-60TH ST.

-61ST ST.

-62ND ST.

-63RD ST.

-64TH ST.

-65TH ST.

-66TH ST.

-67TH ST.

-68TH ST.

-69TH ST.

-70TH ST.

-71ST ST.

-72ND ST.

-73RD ST.

-74TH ST.

-75TH ST.

-76TH ST.

-77TH ST.

-78TH ST.

-79TH ST.

-80TH ST.

-81ST ST.

-82ND ST.

-83RD ST.

-84TH ST.

-85TH ST.

-86TH ST.

-87TH ST.

-88TH ST.

-89TH ST.

-90TH ST.

-91ST ST.

-92ND ST.

-93RD ST.

-94TH ST.

-95TH ST.

-96TH ST.

-97TH ST.

-98TH ST.

-99TH ST.

-100TH ST.

-101ST ST.

-102ND ST.

-103RD ST.

-104TH ST.

-105TH ST.

-106TH ST.

-107TH ST.

-108TH ST.

-109TH ST.

-110TH ST.

-111ST ST.

-112ND ST.

-113RD ST.

-114TH ST.

-115TH ST.

-116TH ST.

-117TH ST.

-118TH ST.

-119TH ST.

-120TH ST.

-121ST ST.

-122ND ST.

-123RD ST.

-124TH ST.

-125TH ST.

-126TH ST.

-127TH ST.

-128TH ST.

-129TH ST.

-130TH ST.

-131ST ST.

-132ND ST.

-133RD ST.

-134TH ST.

-135TH ST.

-136TH ST.

-137TH ST.

-138TH ST.

-139TH ST.

-140TH ST.

-141ST ST.

-142ND ST.

-143RD ST.

-144TH ST.

-145TH ST.

-146TH ST.

-147TH ST.

-148TH ST.

-149TH ST.

-150TH ST.

-151ST ST.

-152ND ST.

-153RD ST.

-154TH ST.

-155TH ST.

-156TH ST.

-157TH ST.

-158TH ST.

-159TH ST.

-160TH ST.

-161ST ST.

-162ND ST.

-163RD ST.

-164TH ST.

-165TH ST.

-166TH ST.

-167TH ST.

-168TH ST.

-169TH ST.

-170TH ST.

-171ST ST.

-172ND ST.

-173RD ST.

-174TH ST.

-175TH ST.

-176TH ST.

-177TH ST.

-178TH ST.

-179TH ST.

-180TH ST.

-181ST ST.

-182ND ST.

-183RD ST.

-184TH ST.

-185TH ST.

-186TH ST.

-187TH ST.

-188TH ST.

-189TH ST.

-190TH ST.

-191ST ST.

-192ND ST.

-193RD ST.

-194TH ST.

-195TH ST.

-196TH ST.

-197TH ST.

-198TH ST.

-199TH ST.

-200TH ST.



1

11
1078
749
748
746
744
742
740
738
736
735
734
732
731
730
729
728
727
726
725
724
723
722
721
720
719
718
717
716
715
714
713
712
711
710
709
708
707
706
705
704
703
702
701
806
805
804
803
802
801
800
799
798
797
796
795
794
793
792
791
790
789
788
787
786
785
784
783
782
781
780
779
778
777
776
775
774
773
772
771
770
769
768
767
766
765
764
763
762
761
760
759
758
757
756
755
754
753
752
751
750
749
748
747
746
745
744
743
742
741
740
739
738
737
736
735
734
733
732
731
730
729
728
727
726
725
724
723
722
721
720
719
718
717
716
715
714
713
712
711
710
709
708
707
706
705
704
703
702
701
806
805
804
803
802
801
800
799
798
797
796
795
794
793
792
791
790
789
788
787
786
785
784
783
782
781
780
779
778
777
776
775
774
773
772
771
770
769
768
767
766
765
764
763
762
761
760
759
758
757
756
755
754
753
752
751
750
749
748
747
746
745
744
743
742
741
740
739
738
737
736
735
734
733
732
731
730
729
728
727
726
725
724
723
722
721
720
719
718
717
716
715
714
713
712
711
710
709
708
707
706
705
704
703
702
701
806
805
804
803
802
801
800
799
798
797
796
795
794
793
792
791
790
789
788
787
786
785
784
783
782
781
780
779
778
777
776
775
774
773
772
771
770
769
768
767
766
765
764
763
762
761
760
759
758
757
756
755
754
753
752
751
750
749
748
747
746
745
744
743
742
741
740
739
738
737
736
735
734
733
732
731
730
729
728
727
726
725
724
723
722
721
720
719
718
717
716
715
714
713
712
711
710
709
708
707
706
705
704
703
702
701
806
805
804
803
802
801
800
799
798
797
796
795
794
793
792
791
790
789
788
787
786
785
784
783
782
781
780
779
778
777
776
775
774
773
772
771
770
769
768
767
766
765
764
763
762
761
760
759
758
757
756
755
754
753
752
751
750
749
748
747
746
745
744
743
742
741
740
739
738
737
736
735
734
733
732
731
730
729
728
727
726
725
724
723
722
721
720
719
718
717
716
715
714
713
712
711
710
709
708
707
706
705
704
703
702
701
806
805
804
803
802
801
800
799
798
797
796
795
794
793
792
791
790
789
788
787
786
785
784
783
782
781
780
779
778
777
776
775
774
773
772
771
770
769
768
767
766
765
764
763
762
761
760
759
758
757
756
755
754
753
752
751
750
749
748
747
746
745
744
743
742
741
740
739
738
737
736
735
734
733
732
731
730
729
728
727
726
725
724
723
722
721
720
719
718
717
716
715
714
713
712
711
710
709
708
707
706
705
704
703
702
701
806
805
804
803
802
801
800
799
798
797
796
795
794
793
792
791
790
789
788
787
786
785
784
783
782
781
780
779
778
777
776
775
774
773
772
771
770
769
768
767
766
765
764
763
762
761
760
759
758
757
756
755
754
753
752
751
750
749
748

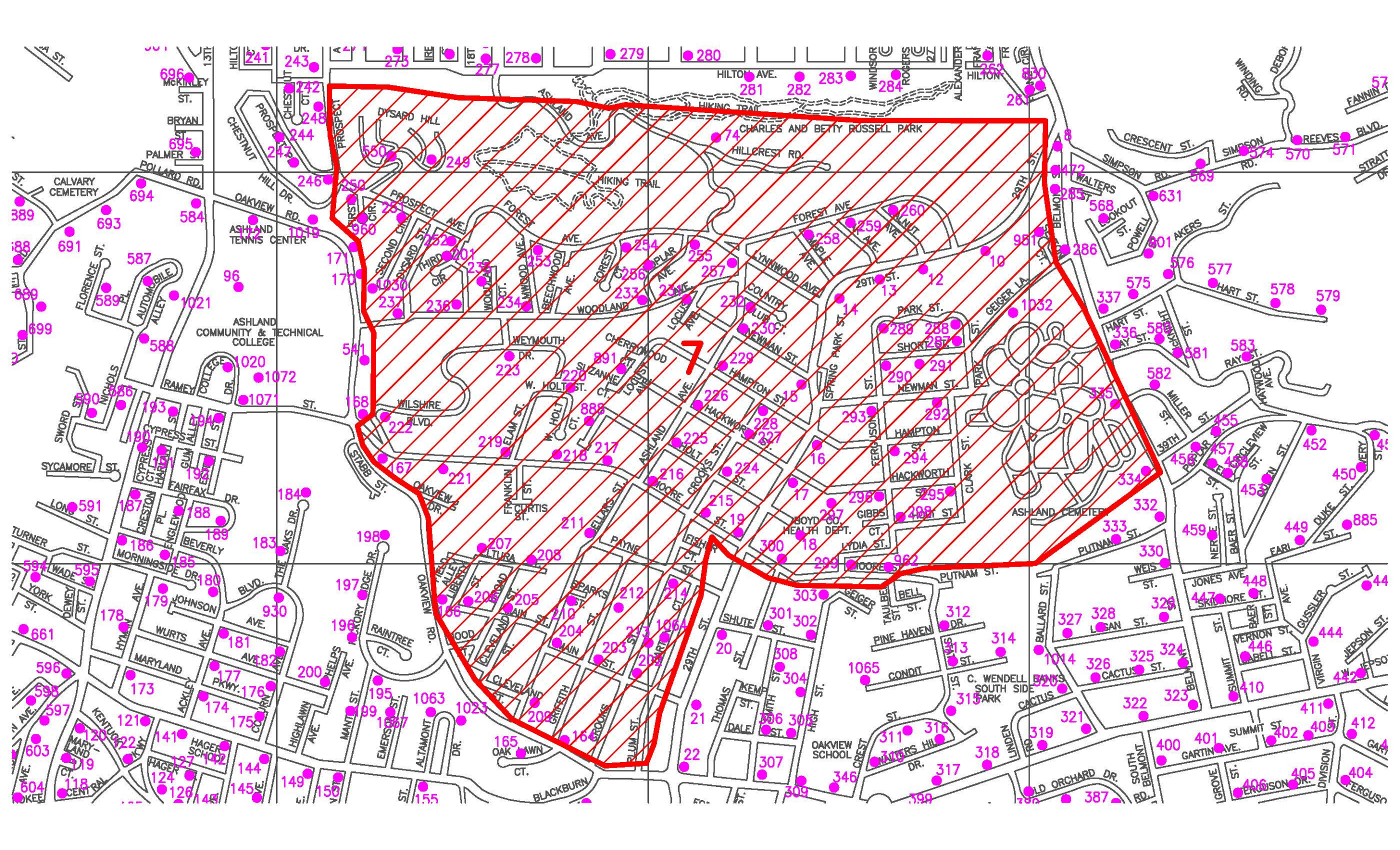

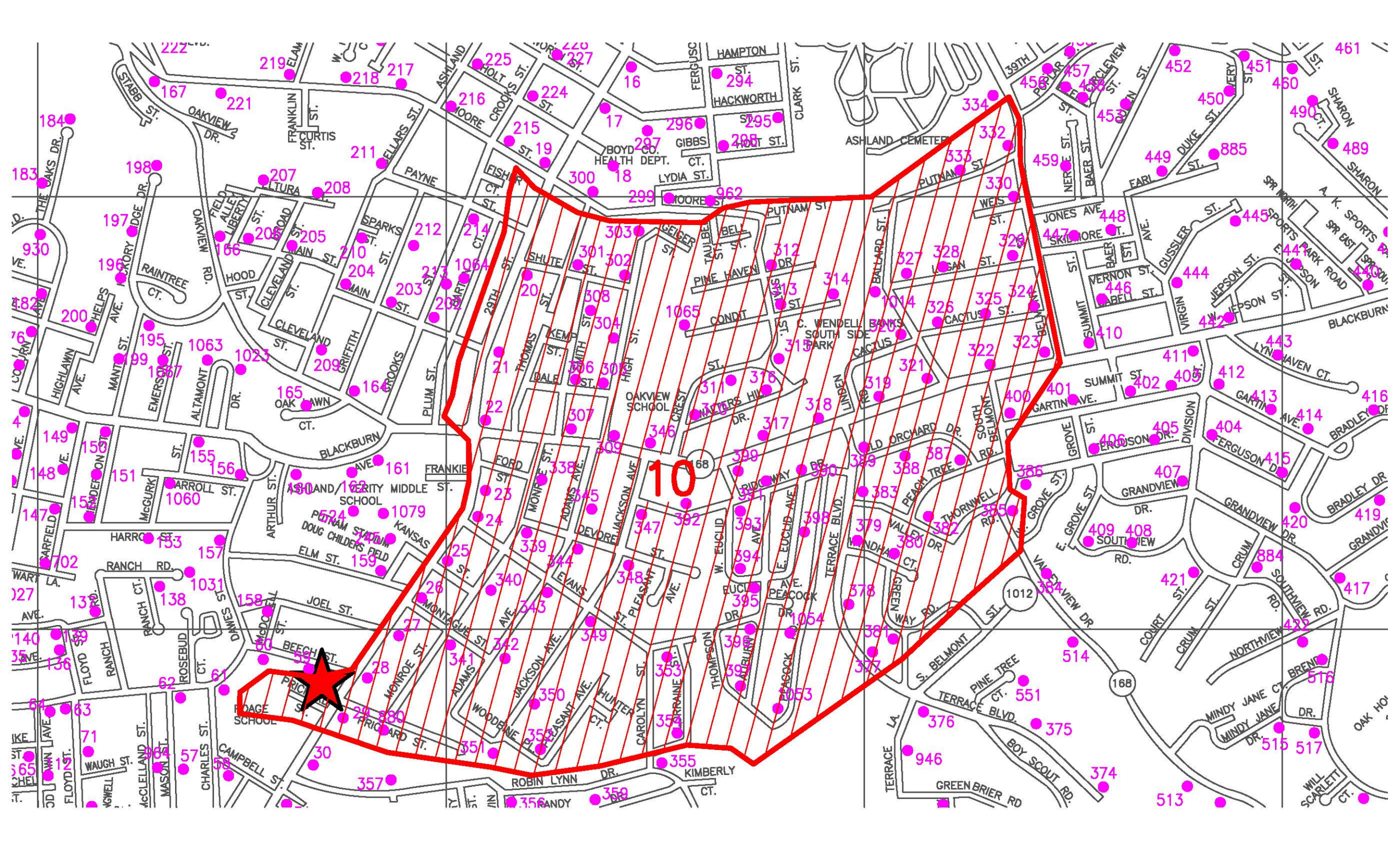

Hydrant Flushing

April 4, 7, 10, 13, 19, 25, and 28, 2023

Enlarged maps may be found at www.ashlandky.gov

Zone 2

From Martin Luther King Blvd. to 21st Street, from the River to Central Avenue. This zone will also include from Martin Luther King Blvd. to 17th Street, from Central Avenue to Lexington Avenue, including Mid-Town Shopping Plaza.

Zone 5

From 31st Street following Winchester Avenue to the Water Treatment Plan. From Winchester Avenue and Blackburn Avenue following Blackburn Avenue to Belmont Street. From Belmont Street to 29th Street including neighborhoods to the east of Belmont Street. This zone will include Debord Terrace Apartments.

Zone 8

13th Street from Shelby to Ramey Street, towards Pollard Road and back to Blackburn Avenue. This zone includes all of Midland Heights.

Zone 11

13th Street from High Street to Boyd Scott Road including Rose Hill School. Out Boy Scout Road to Hogsten Drive. From Hogsten Drive to Lowman Drive out Tanglewood Drive to Wildwood Drive. Extending to Robin Lynn Drive in a straight line to 13th Street.

CONSUMERS ARE ADVISED TO CHECK WATER CONDITIONS PRIOR TO DRAWING WATER FOR CONSUMPTION, COOKING, AND FOR USE IN WASHERS AND DISHWASHERS. There may be a slight drop in pressure or a presence of discoloration from the minerals and sediments being flushed out of the system. If discoloration is found, run water until water clears.

OHIO

RIVER

MILE 323 X

BEN WILLIAMSON MEMORIAL BRIDGE
SIMEON WILLIS BRIDGE

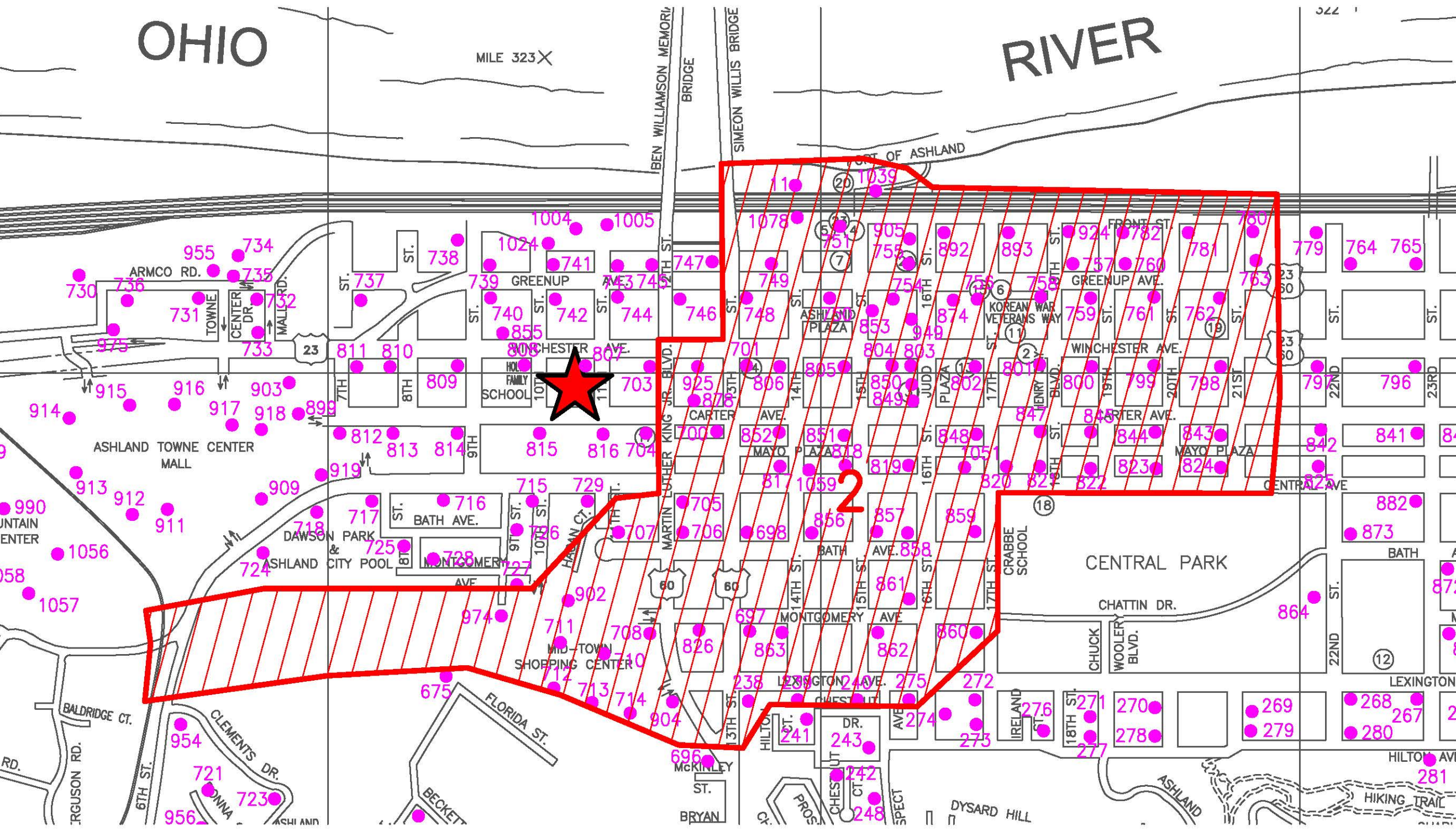

2

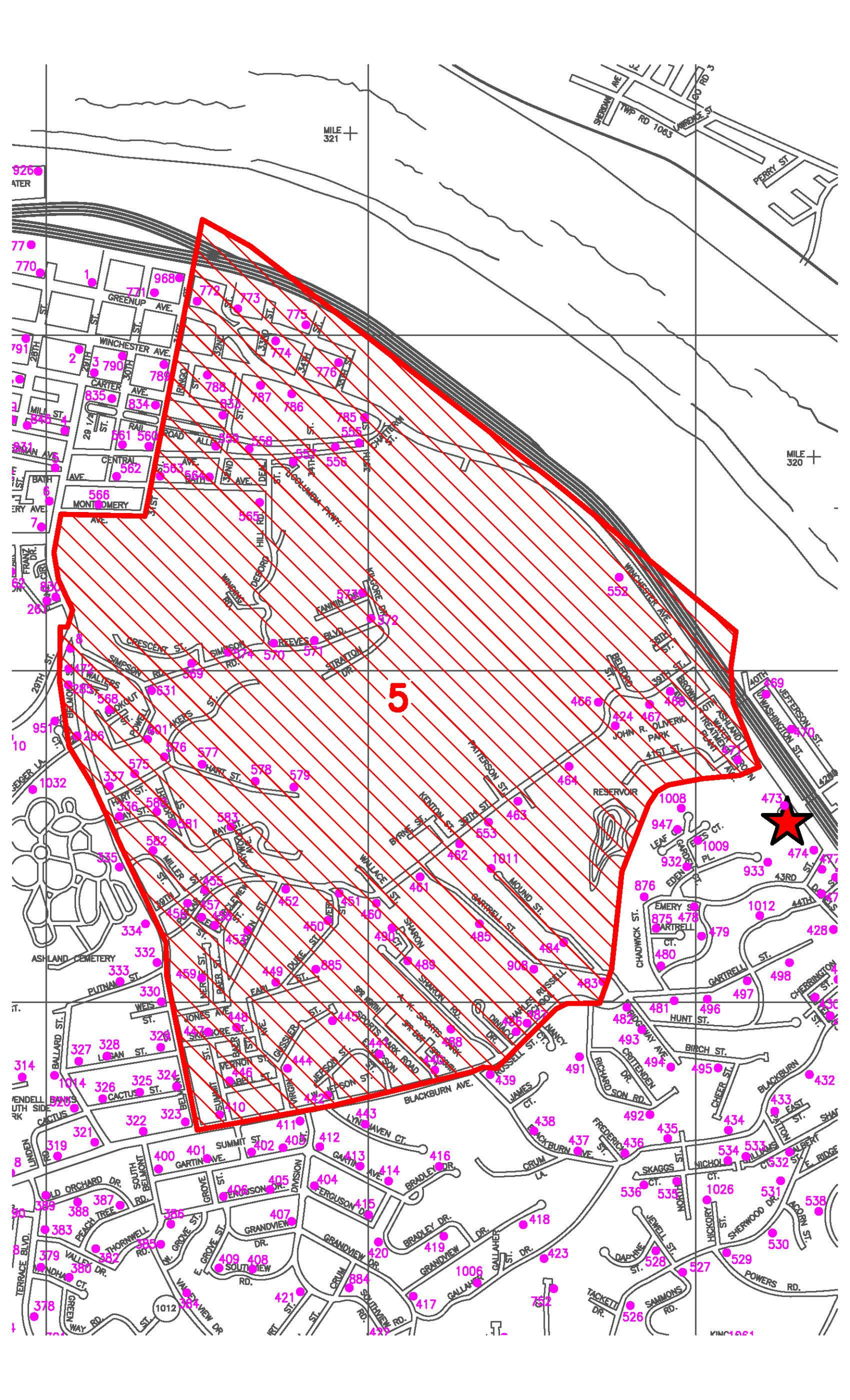

MILE
3/4

MILE
3/4

5



VINC1001

Hydrant Testing

April 5, 11, 14, 17, 20, and 26, 2023

Enlarged maps are available at www.ashlandky.gov

Zone 3

Roberts Drive from Blevins Street to Blackburn Avenue. 6th Street from Blackburn Avenue to Bruce Apartments. Pollard Road from Blackburn Avenue to 13th Street, all neighborhoods on the west side of Pollard Road. 13th Street areas around ACTC and Ashland Tennis Center. West side of Prospect Avenue from Chestnut Hill Drive to Hilton Avenue.

Zone 6

From 40th Street to 55th Street along Winchester Avenue, including the neighborhoods around 47th Street boat ramp. Following 55th Street to Valleyview Drive, Sherwood Drive, from Banbury Road back to Shadowlawn Drive, Blackburn Avenue from Winchester Avenue to Russell Street. This zone will also include Eden Place.

Zone 9

On 13th Street from Corporate Court to Blackburn Avenue. Blackburn Avenue from 13th Street to Oakview Road. This area also includes Hickory Ridge and Oaklawn Court. From 29th Street and Blackburn Avenue to Poage School and from Poage School back to 13th Street.

Zone 12

Boyscout Road, Oakwood Circle, Ashland Park, Terrace Blvd to South Belmont. East side of Valleyview Drive including Sherwood neighborhoods. Grandview Drive and neighborhoods surrounding Division Street, Gartin Avenue, and Ferguson Avenue.

CONSUMERS ARE ADVISED TO CHECK WATER CONDITIONS PRIOR TO DRAWING WATER FOR CONSUMPTION, COOKING, AND FOR USE IN WASHERS AND DISHWASHERS. There may be a slight drop in pressure or a presence of discoloration from the minerals and sediments being flushed out of the system. If discoloration is found, run water until water clears.

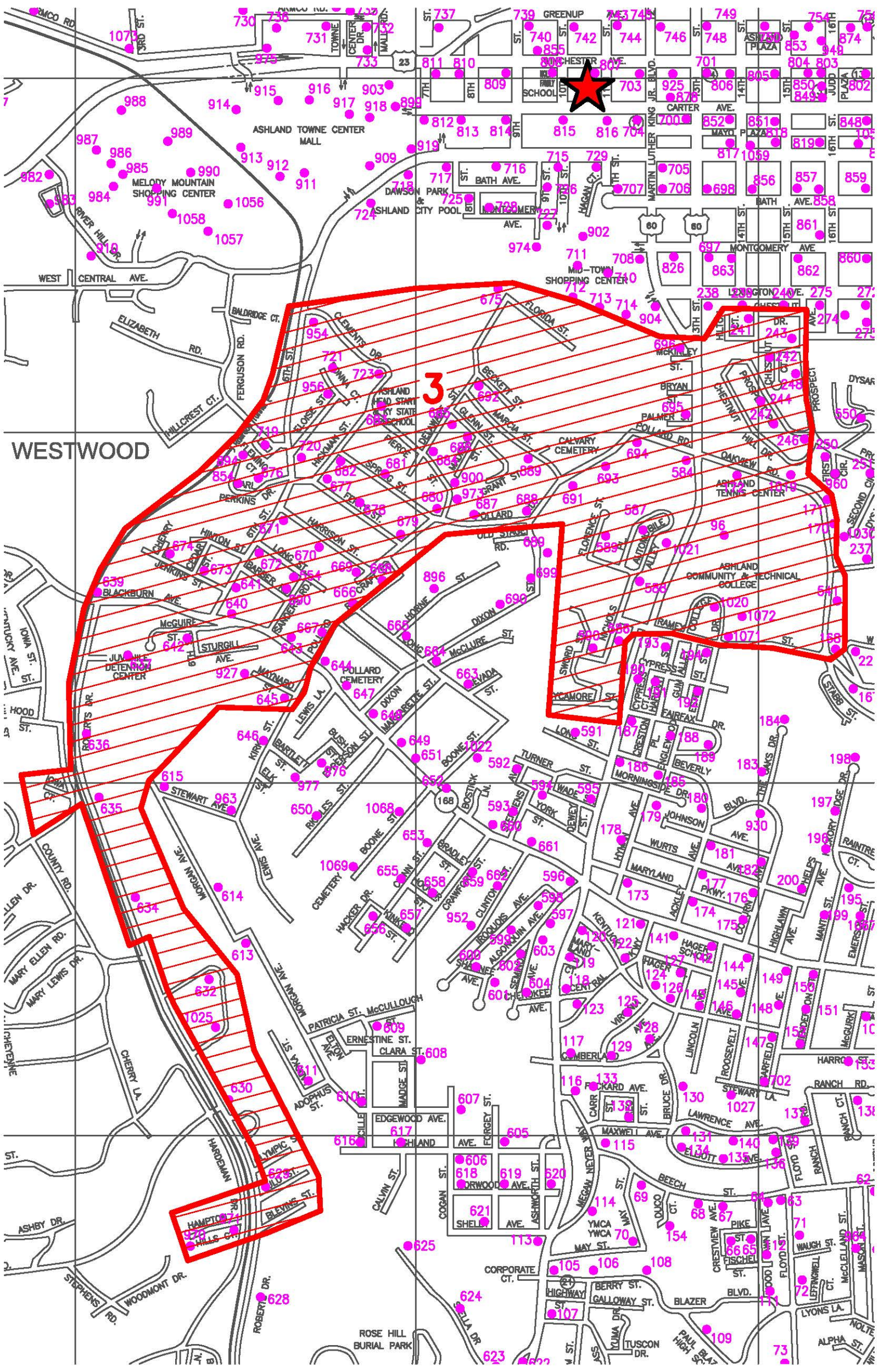

3

WESTWOOD

ASHLAND TOWNE CENTER MALL

MELODY MOUNTAIN SHOPPING CENTER

ASHLAND CITY POOL

MID-TOWN SHOPPING CENTER

ASHLAND COMMUNITY & TECHNICAL COLLEGE

ROSE HILL BURIAL PARK

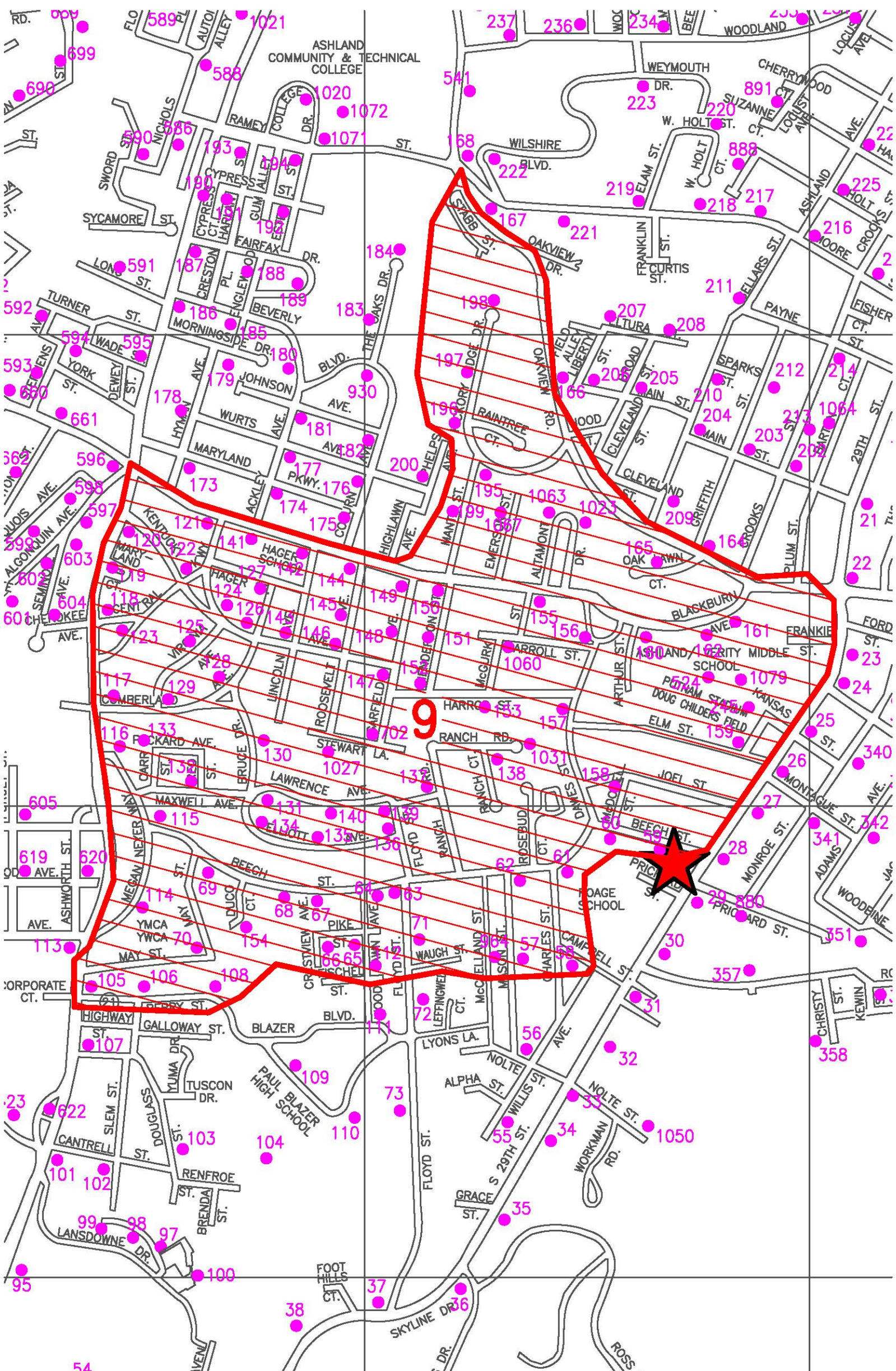

ASHLAND
COMMUNITY & TECHNICAL
COLLEGE

9



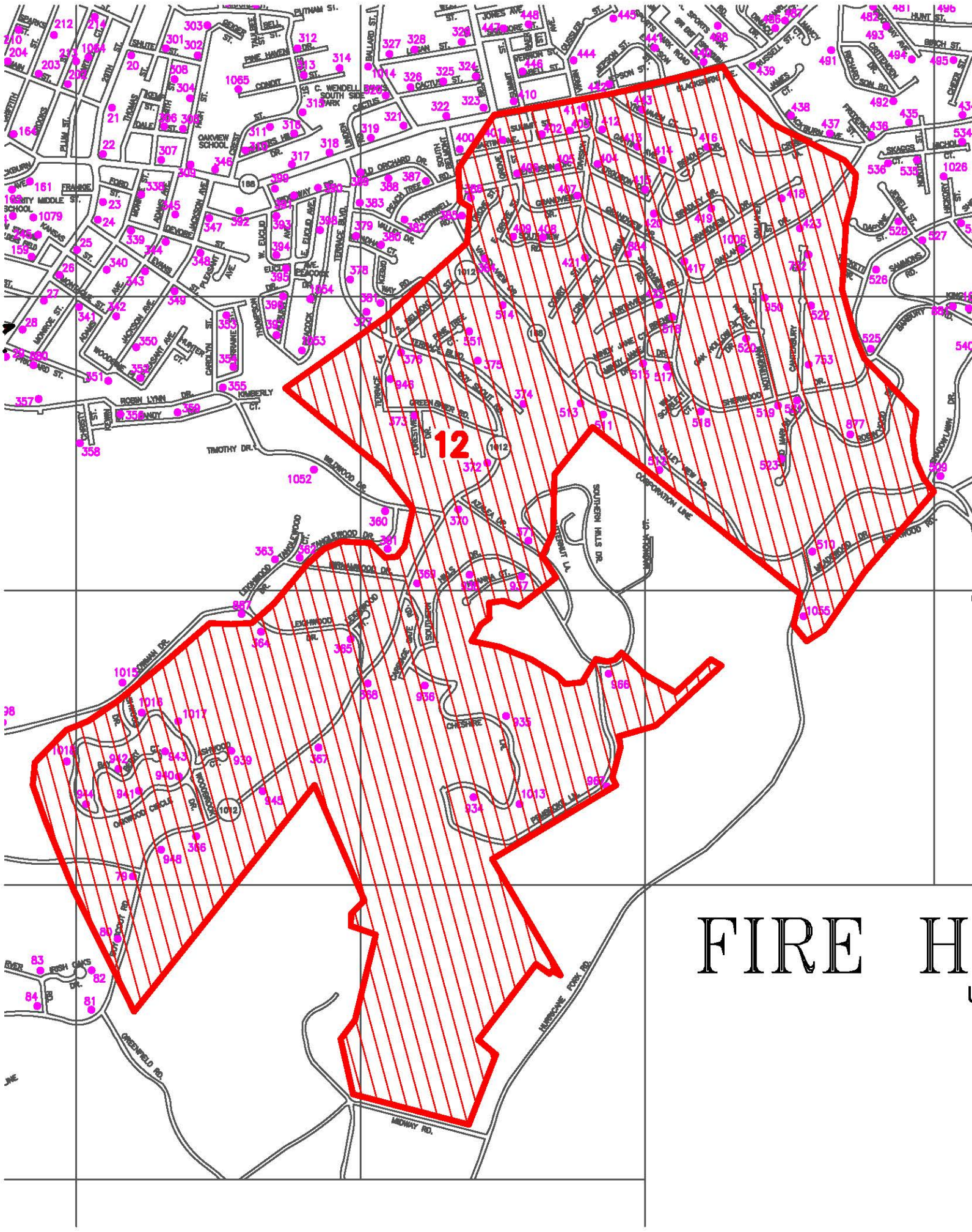

FIRE H